

REV	DATE	DESCRIPTION	DATE	APPD
CM 53		RELEASED PER PR CM 89-170	10-25-89	PC 25

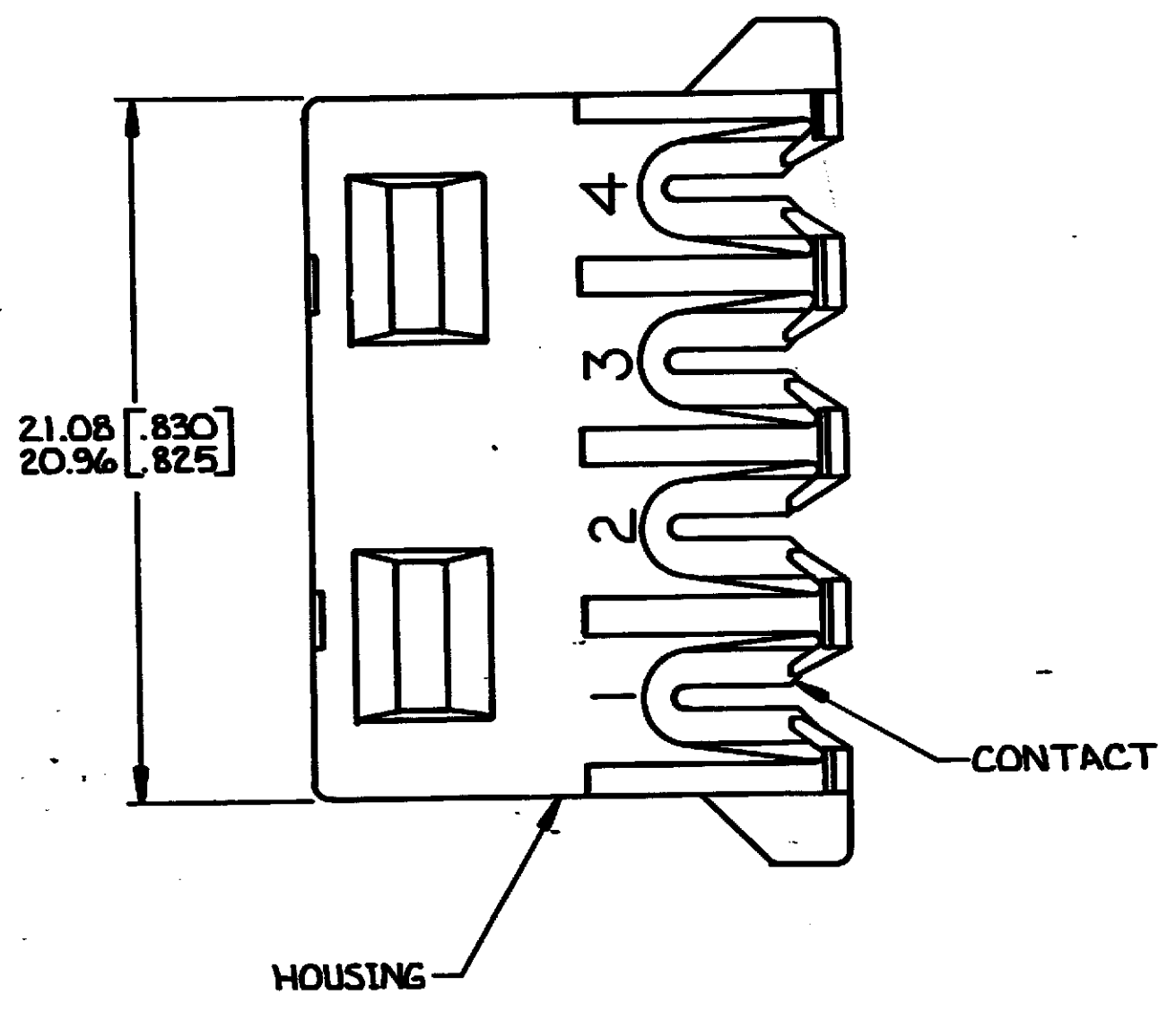

⚠ MATERIAL: HOUSING-NYLON, 94V-2, NATURAL
 CONTACT-PH BRZ (PRE-TIN PLATE
 0.00076 [.000030] MIN. THK)
 2. DIMENSIONS IN BRACKETS ARE IN INCHES.

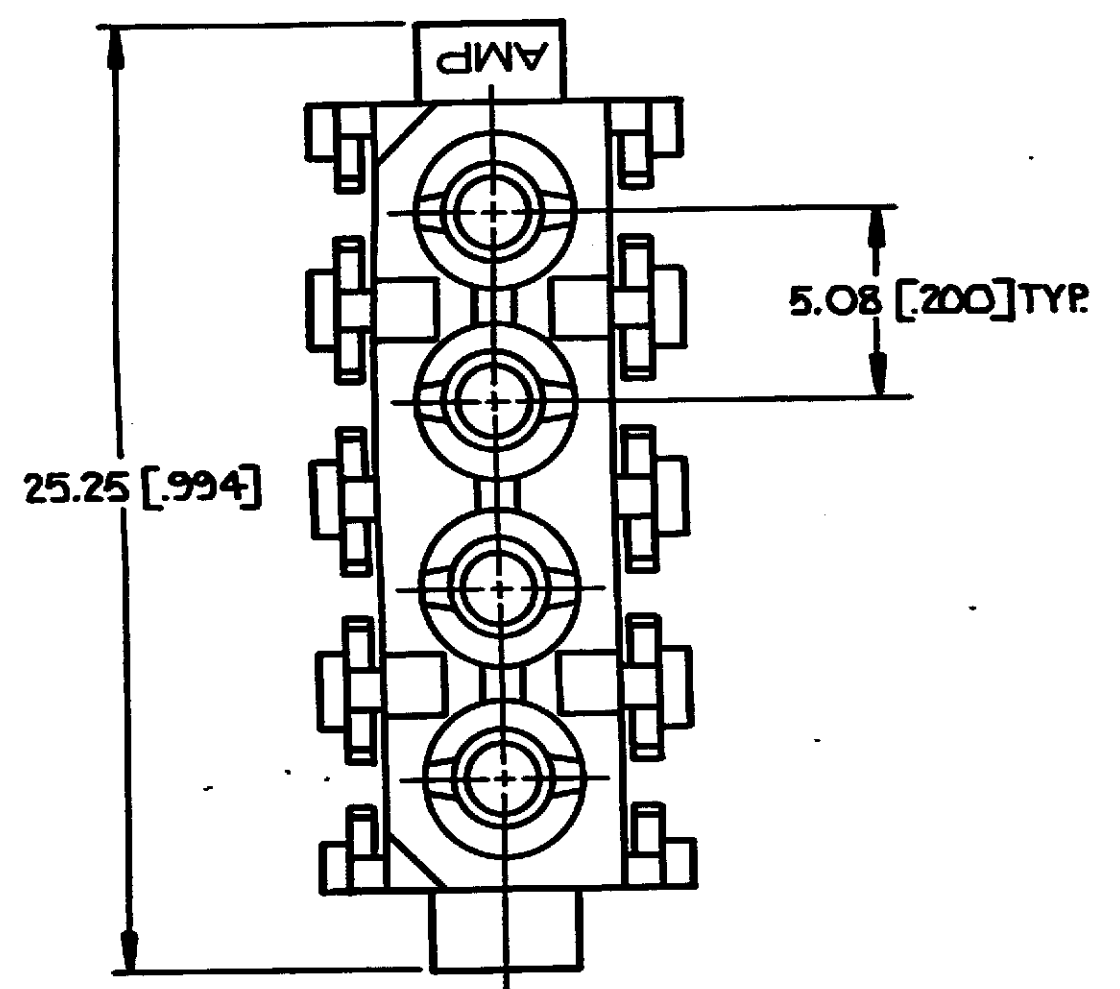
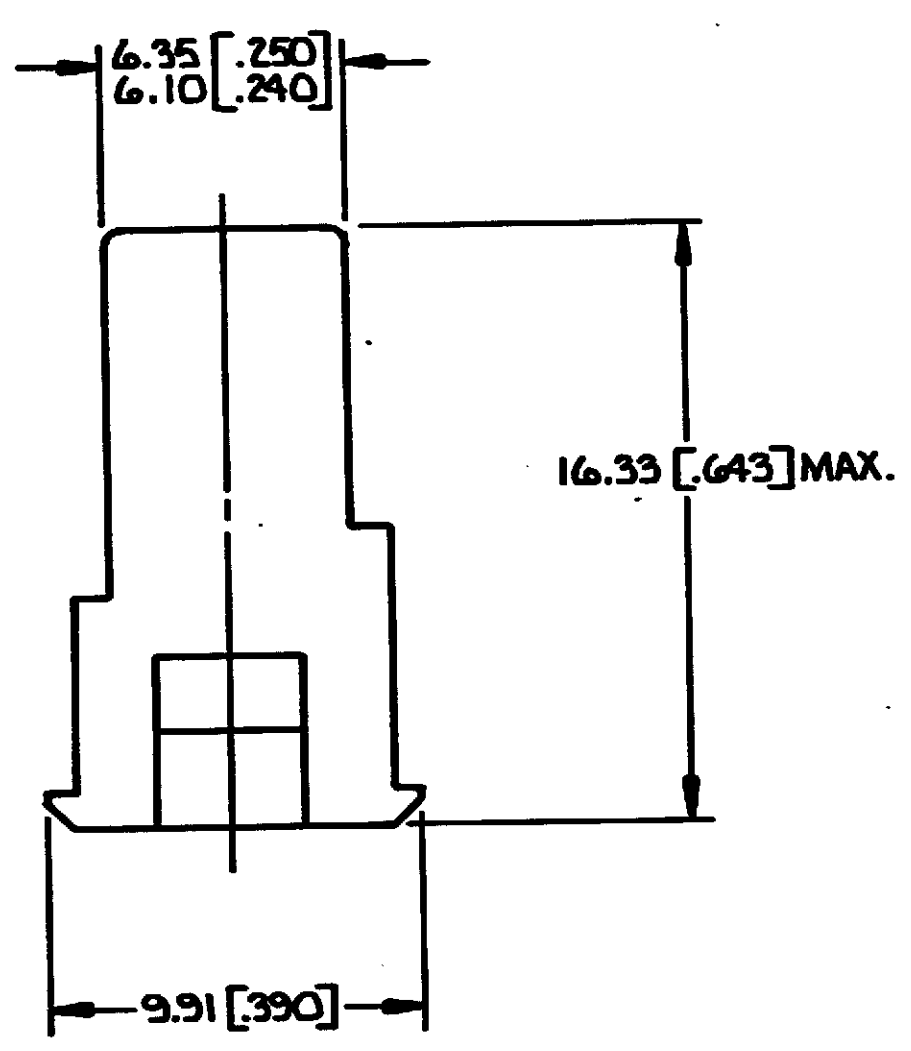

METRIC

UNLESS OTHERWISE SPECIFIED DIMENSIONS ARE IN MM		DR <i>P. Collins</i> 10-25-89		18 AWG 770643-1	
TOLERANCES ON		CHK <i>R. Irving</i> 10-30-89		WIRE SIZE	
2 PL DEC ±		APP <i>G. Brown</i> 10-30-89		PART NO	
3 PL DEC ± 0.13 [.005]		APPD		AMP AMP INCORPORATED Harrisburg, Pa. 17105	
ANGLES ±		PRODUCT SPEC		NAME PLUG ASSEMBLY, INSULATION DISPLACEMENT, COMMERCIAL MATE-N-LOK™	
MATERIAL ⚠		APPLICATION SPEC		SIZE	FSCM NO
FINISH ⚠		WEIGHT		C	00779
				SCALE	5:1
				DRAWING NO 770643	
				SHEET 1 OF 1	

CUSTOMER DRAWING